

**MİMARİ KATALOG**  
**ARCHITECTURAL CATALOGUE**

**Alüminyum Kapı Pencere ve Giydirme Cephe Sistemleri**  
Aluminium Window Doors and Facade Systems

**RESCARA**

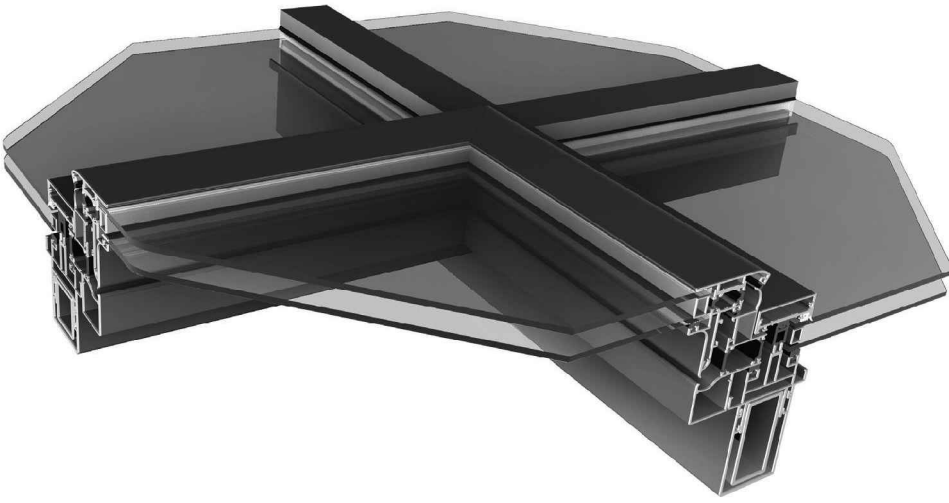

**SKY 65**



# MİMARİ KATALOG ARCHITECTURAL CATALOGUE

Alüminyum Kapı Pencere ve Giydirme Cephe Sistemleri  
Aluminium Window Doors and Facade Systems



Rescara Sistem Detayları  
Rescara System Details

# SKY65

PROFİLLER

PROFILES

01

02

03

04

05

06

07

08

09

10

DÜŞEY VE YATAY PROFİLLER  
MULLION AND TRANSOM PROFILES

# SKY65

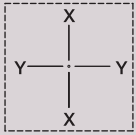
KOD / CODE	AĞIRLIK (kg/m) / WEIGHT	Jxx cm4	Jyy cm4	L m	
R50 M 16	1,972	40,203	21,856	6	
R50 T 11	2,085	44,694	22,469	6	

R50 M 16

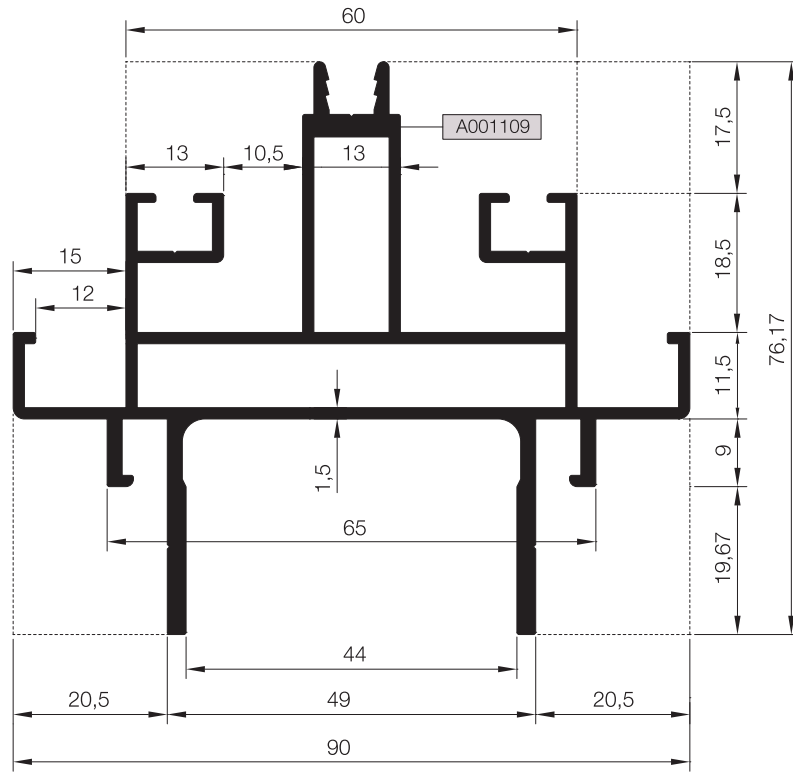

R50 T 11

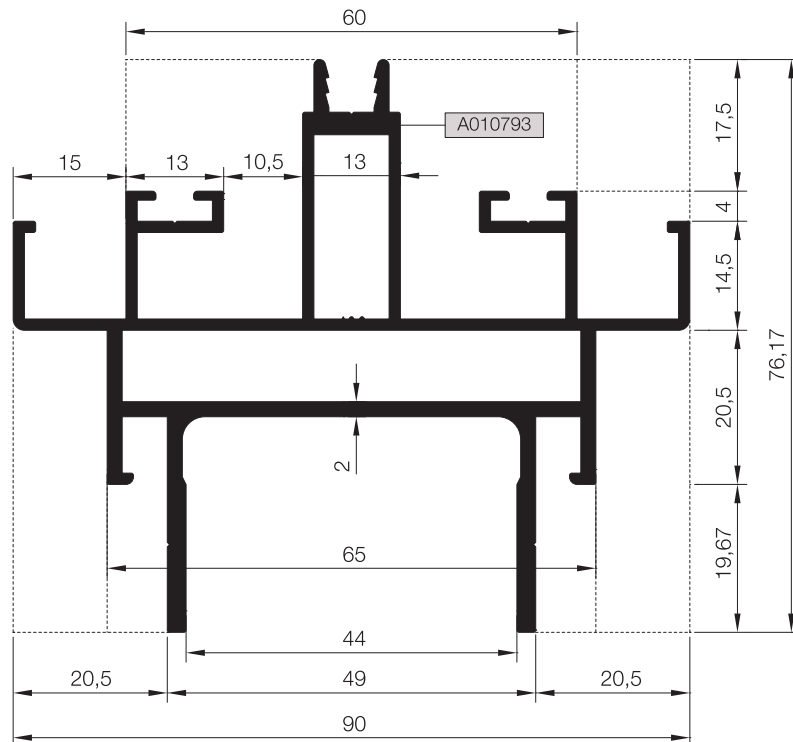

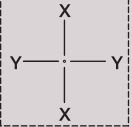
KOD / CODE	AĞIRLIK (kg/m) / WEIGHT	Jxx cm4	Jyy cm4	L m	
R50 T 10	2,077	47,190	25,938	6	
R50 T 09	1,101	25,071	3,889	6	

R50 T 10

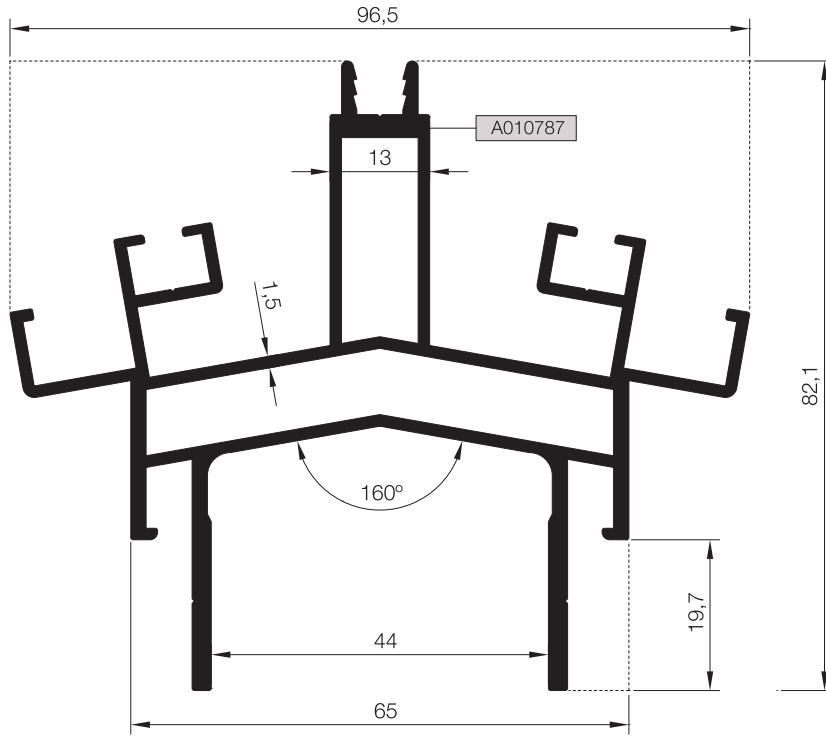

R50 T 09

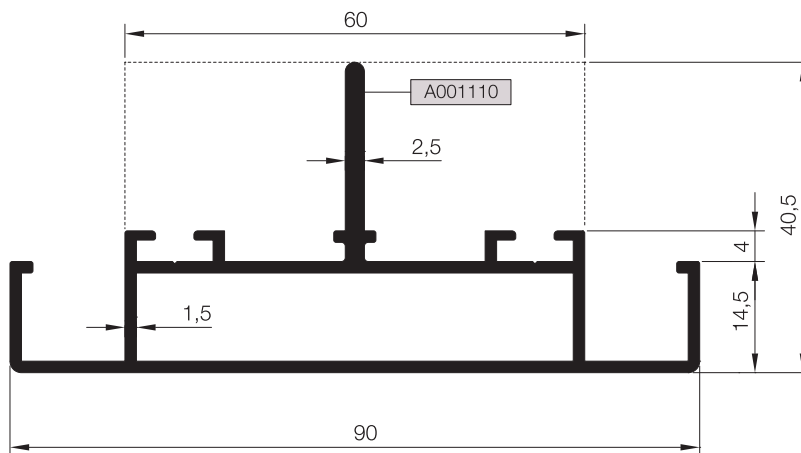

DÜŞEY VE YATAY PROFİLLER  
MULLION AND TRANSOM PROFILES

# SKY65

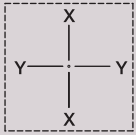
KOD / CODE	AĞIRLIK (kg/m) / WEIGHT	Jxx cm <sup>4</sup>	Jyy cm <sup>4</sup>	L m	
R50 M 10	2,565	21,713	86,773	6	
R50 T 07	1,052	9,560	4,362	6	

01

02

03

04

05

06

07

08

09

10

R50 M 10

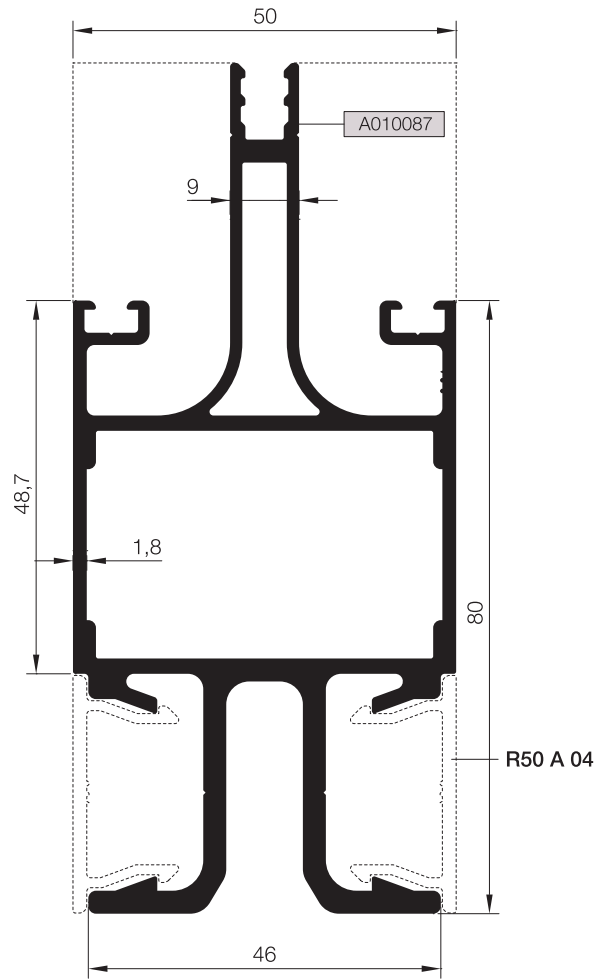

R50 T 07

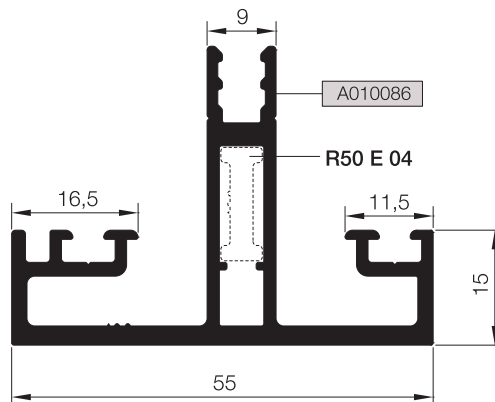

KAPAK PROFİLLERİ  
CAP PROFILES

# SKY65

KOD / CODE	AĞIRLIK (kg/m) / WEIGHT	L m
R50 P 33	2,997	6
K50 P 18	2,313	6

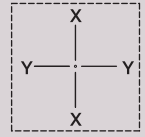

R50 P 33

K50 P 18

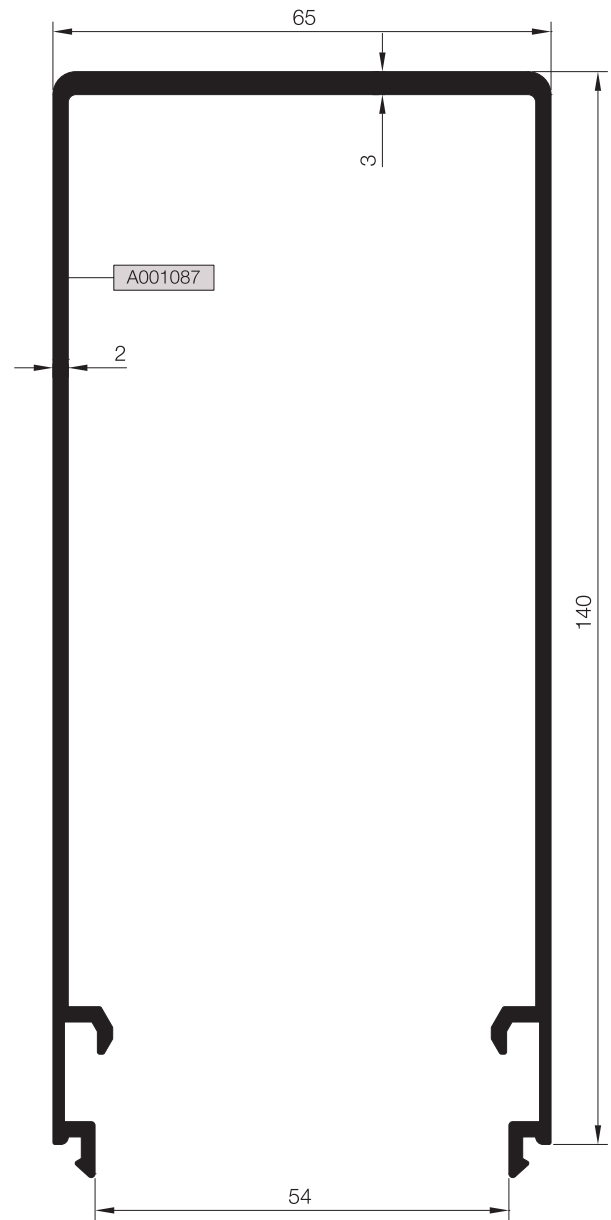
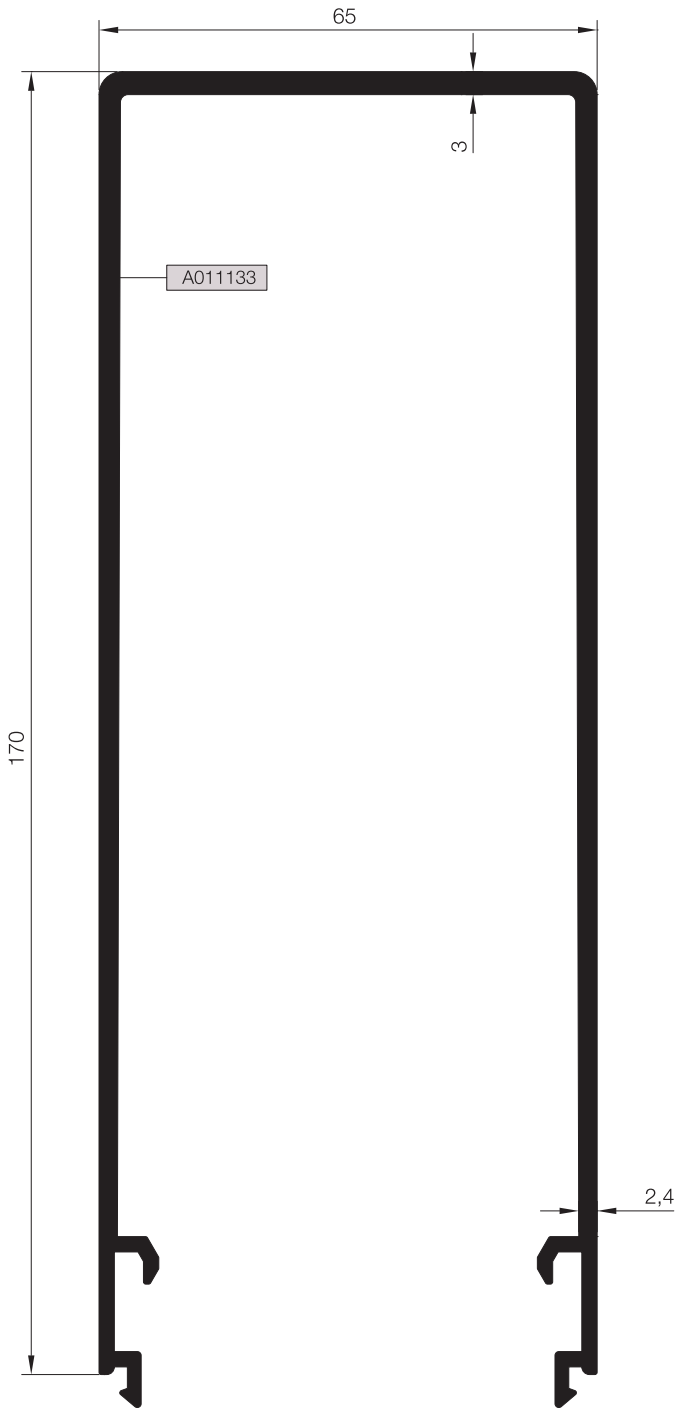

01

02

03

04

05

06

07

08

09

10

KAPAK PROFİLLERİ  
CAP PROFILES

# SKY65

KOD / CODE	AĞIRLIK (kg/m) / WEIGHT	L m	
K50 P 19	1,336	6	
K50 P 20	0,901	6	

01

02

03

04

05

06

07

08

09

10

K50 P 19

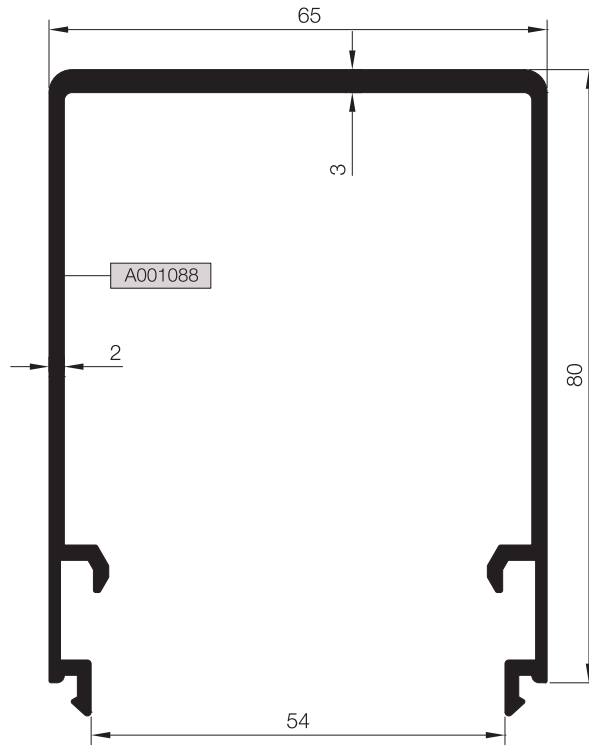

K50 P 20

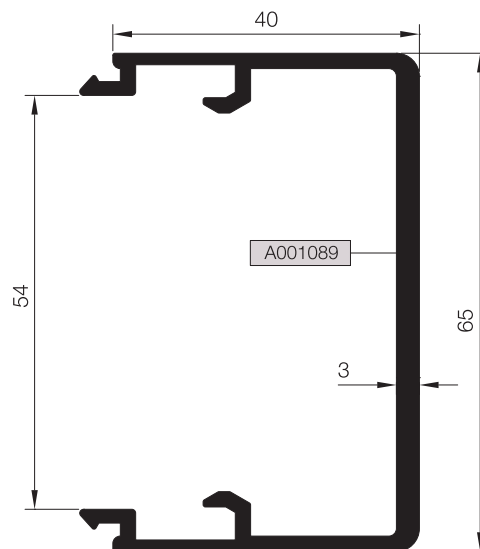



**BASKI KAPAK VE CAM DESTEK PROFİLLERİ**  
**CAP AND GLASS SUPPORT PROFILES**

# SKY65

KOD / CODE	AĞIRLIK (kg/m) / WEIGHT	L m	KOD / CODE	AĞIRLIK (kg/m) / WEIGHT	L m
R50 P 05	0,566	6	R50 A 04	0,245	6
R50 P 04	0,455	6	R50 E 04	0,146	6
R50 P 21	0,872	6	R50 S 03	0,362	6
R50 P 22	0,580	6			

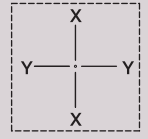

**R50 P 05**

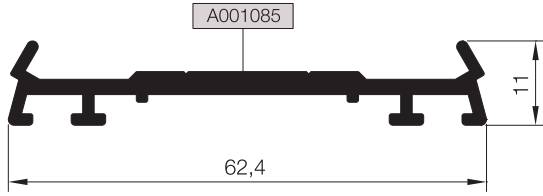

**R50 P 04**

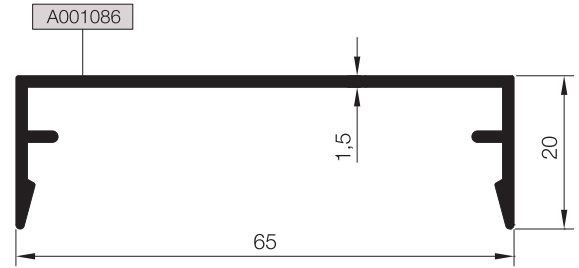

**R50 P 21**

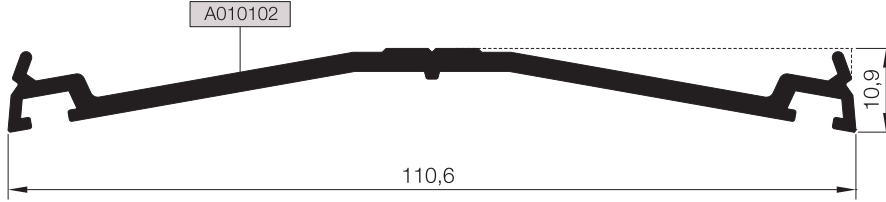

**R50 P 22**

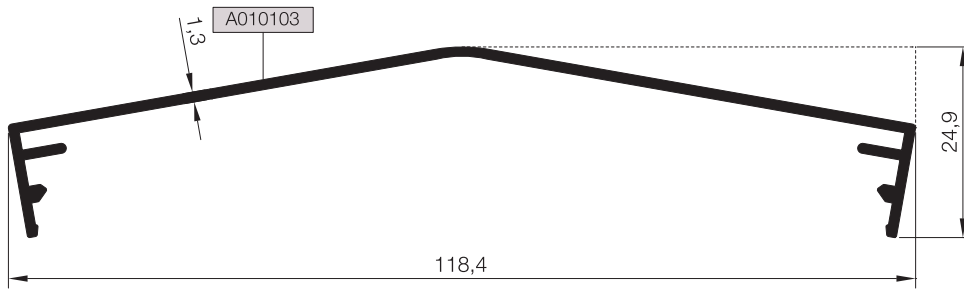

**R50 A 04**

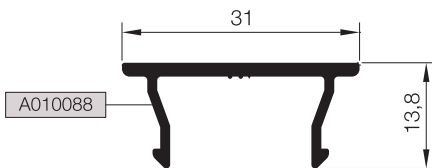

**R50 E 04**

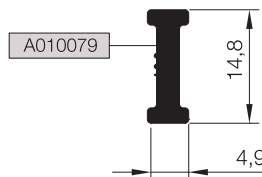

**R50 S 03**

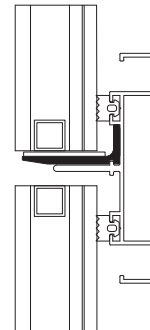
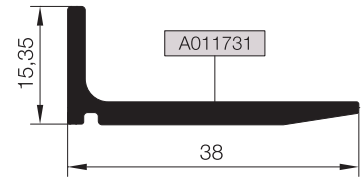

Ölçek/Scale: 1/3

01

02

03

04

05

06

07

08

09

10

KASA PROFİLLERİ  
FRAME PROFILES

# SKY65

KOD / CODE	AĞIRLIK (kg/m) / WEIGHT	L m
AR50M22	1,728	6
AR50M23	1,660	6

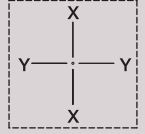

AR50M22

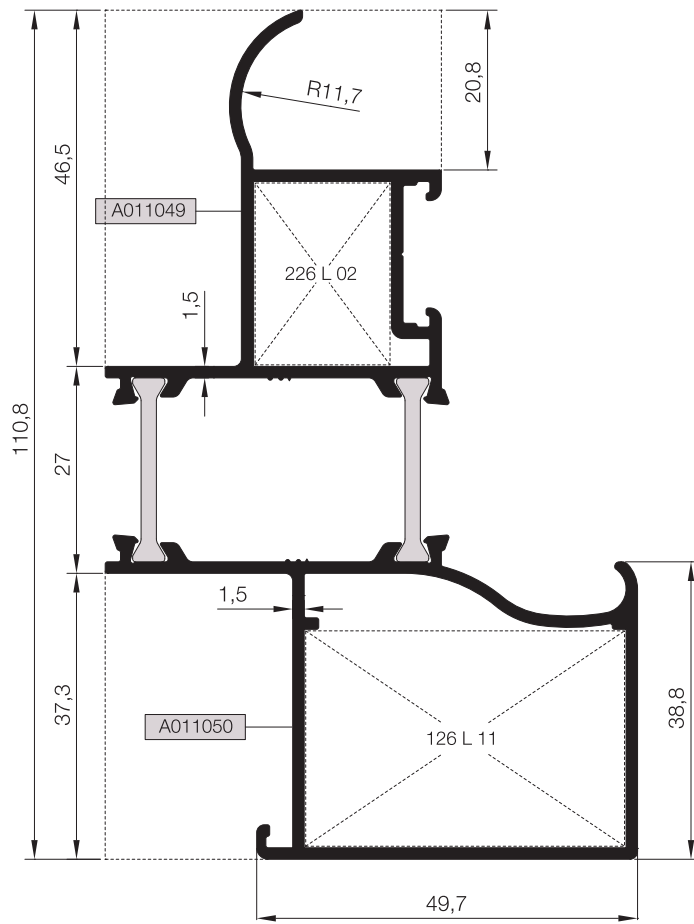

AR50M23

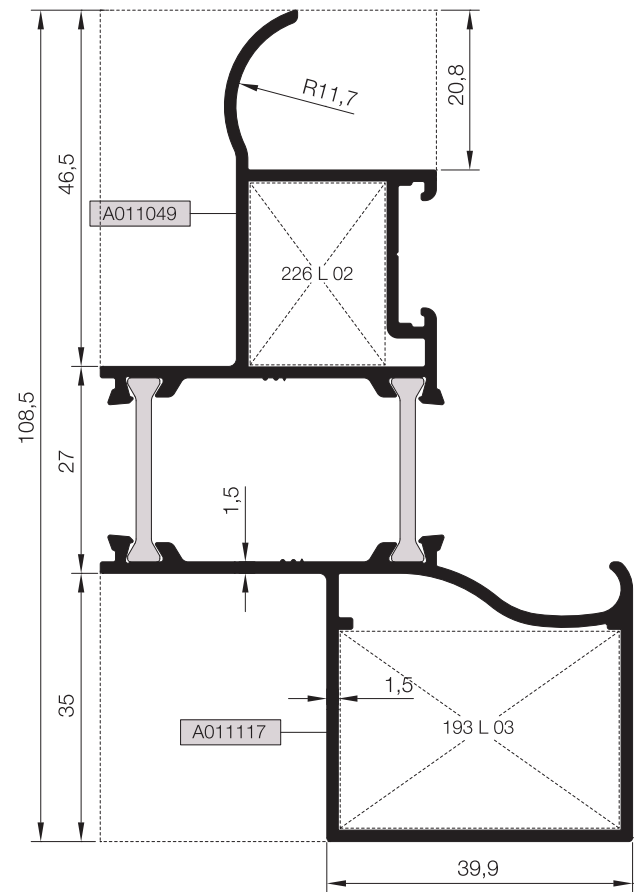

Nr	KÖŞE BAĞLANTI PROFİLİ PROFİL KOD NUMARASI	KÖŞE BAĞLANTI PROFİLİ PARÇA KOD NUMARASI	KESİM ÖLÇÜSÜ CUTTING SIZE
AR50M22	A011049	A002020 (25 L 02)	23,8 mm
	A011050	A002126 (25 L 11)	28,1 mm
AR50M23	A011049	A002020 (25 L 02)	23,8 mm
	A011117	A002021 (25 L 03)	25,9 mm

# KANAT PROFİLLERİ

## VENT PROFILES

# SKY65

KOD / CODE	AĞIRLIK (kg/m) / WEIGHT	L m	
AR50V20	1,216	6	
R50 R 12	0,643	6	

### AR50V20

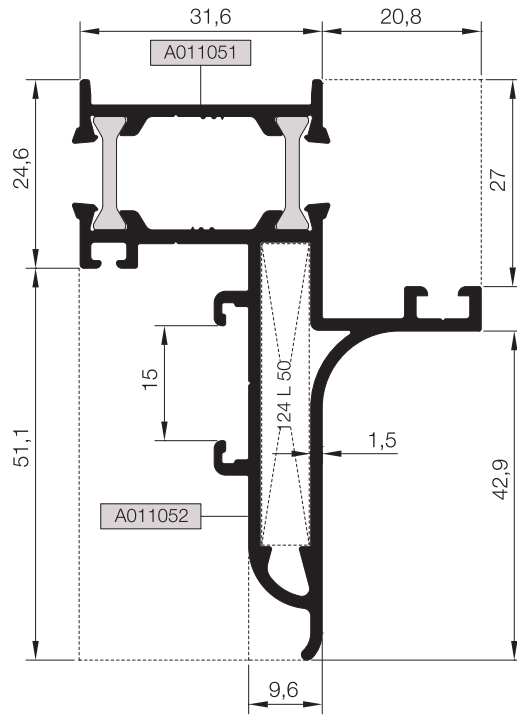

### R50 R 12

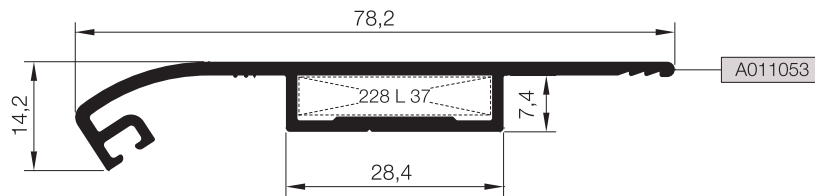

Nr	KÖŞE BAĞLANTI PROFİLİ PROFİL KOD NUMARASI	KÖŞE BAĞLANTI PROFİLİ PARÇA KOD NUMARASI	KESİM ÖLÇÜSÜ CUTTING SIZE
AR50V20	A011052	A010838 (25 L 50)	39,3 mm
R50 R 12	A011053	A002398 (25 L 37)	5,1 mm

# KÖŞE TAKOZLARI CORNER CLEATS

# SKY65

PROFİL KODU (PROFILE CODE)	25 L 02	25 L 03	25 L 11	25 L 37
FABRİKA KODU (FACTORY CODE)	A002020	A002021	A002126	A002398
AĞIRLIK (WEIGHT)	4,943 kg/m	4,315 kg/m	6,733 kg/m	7,971 kg/m
ÇİZİM (DRAWING)				

PROFİL KODU (PROFILE CODE)	25 L 50			
FABRİKA KODU (FACTORY CODE)	A010838			
AĞIRLIK (WEIGHT)	1,748 kg/m			
ÇİZİM (DRAWING)				

Nr		KESİM ÖLÇÜSÜ CUTTING SIZE	AKS. KODU ACS. CODE	
AR50M22	A011049	25 L 02 (A002020)	23,8 mm	226 L 02
	A011050	25 L 11 (A002126)	28,1 mm	126 L 11
AR50M23	A011049	25 L 02 (A002020)	23,8 mm	226 L 02
	A011117	25 L 03 (A002021)	25,9 mm	193 L 03
AR50V20	A011052	25 L 50 (A010838)	39,3 mm	124 L 50
R50 R 12	A011053	25 L 37 (A002398)	5,1 mm	228 L 37

## STOKTA BULUNAN SİSTEM PROFİLLERİNİN LİSTESİ (LIST OF SYSTEM PROFILES IN STOCK)

Nr	MIN. SİPARİŞ MİKTARI MIN. ORDER QUANTITY	
R50 M 16	A001109	75 kg
R50 T 11	A010793	75 kg
R50 P 04	A001086	75 kg
R50 P 05	A001085	75 kg
K50 P 19	A001088	75 kg

\* STOKTA BULUNMAYAN TÜM PROFİLLER İÇİN MİNİMUM SİPARİŞ MİKTARI 300\*KG'DİR.  
MINIMUM ORDER QUANTITY FOR ALL THE PROFILES THAT ARE NOT IN STOCK IS 300 KG.

# MİMARİ KATALOG ARCHITECTURAL CATALOGUE

Alüminyum Kapı Pencere ve Giydirme Cephe Sistemleri  
Aluminium Window Doors and Facade Systems



Rescara Sistem Detayları  
Rescara System Details

# SKY65

DETAYLAR

DETAILS

01

02

03

04

05

06

07

08

09

10

- 01
- 02
- 03
- 04
- 05
- 06
- 07
- 08
- 09
- 10

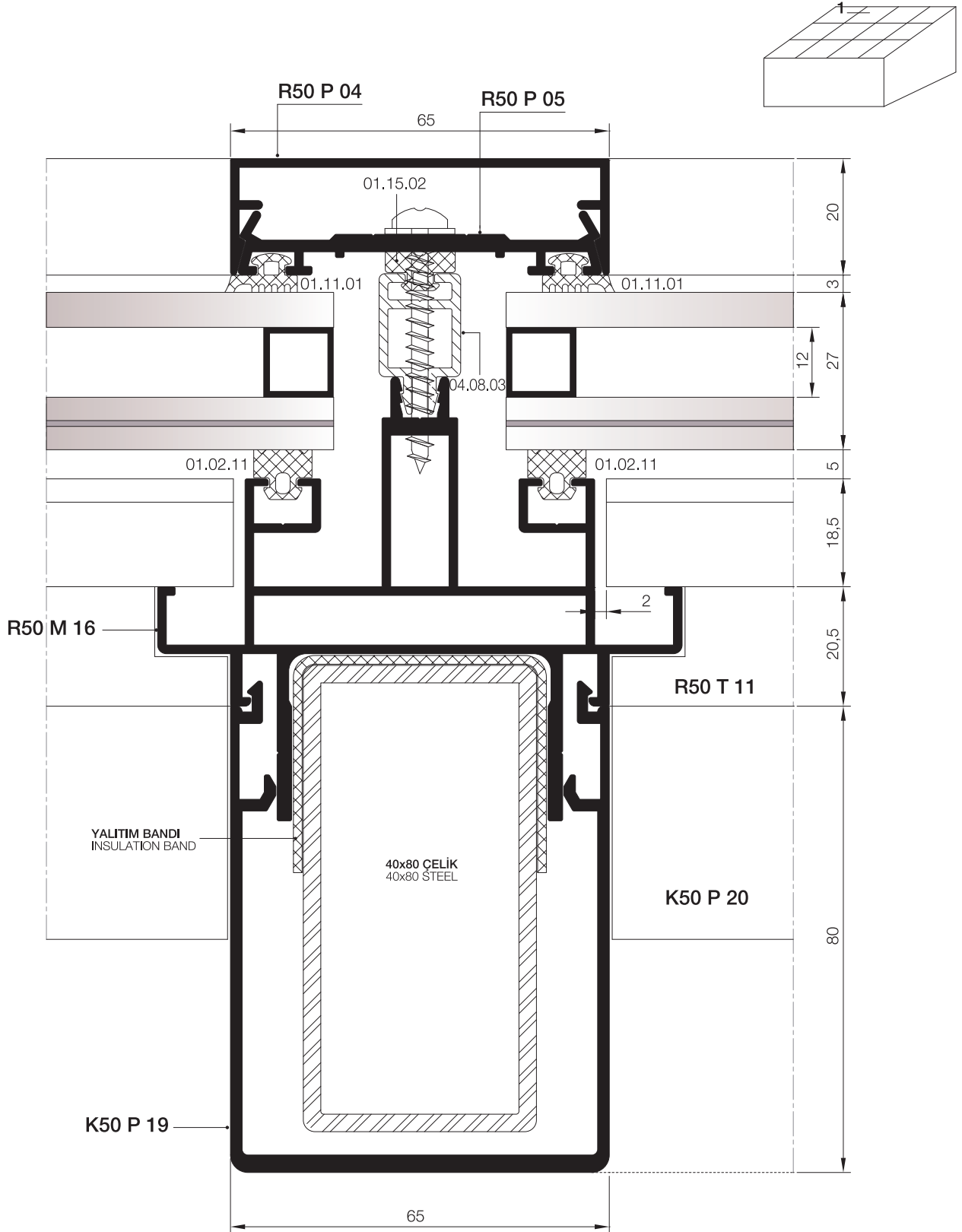

① DETAYI  
DETAIL

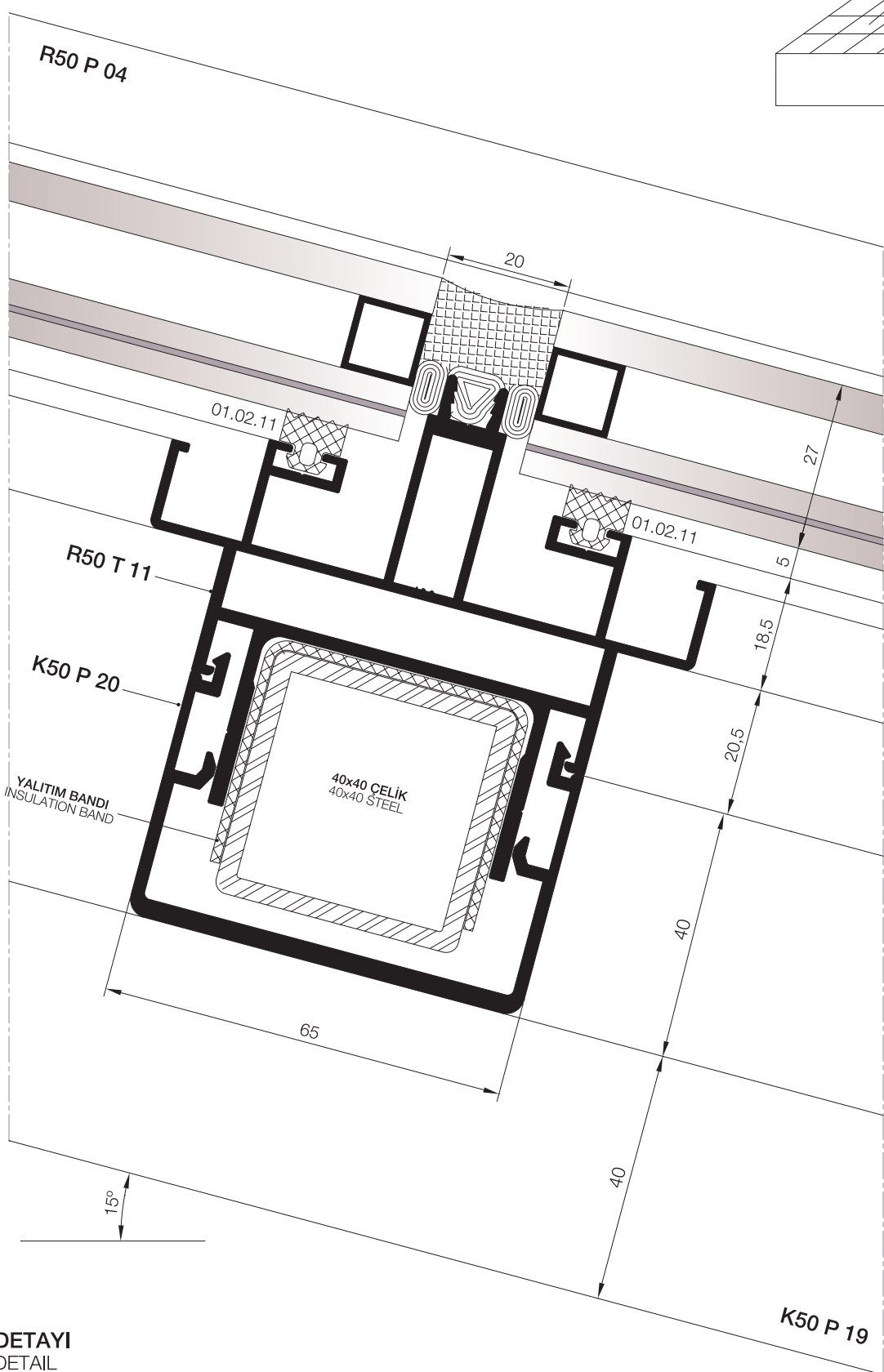

② DETAYI  
DETAIL

01

02

03

04

05

06

07

08

09

10

01

02

03

04

05

06

07

08

09

10

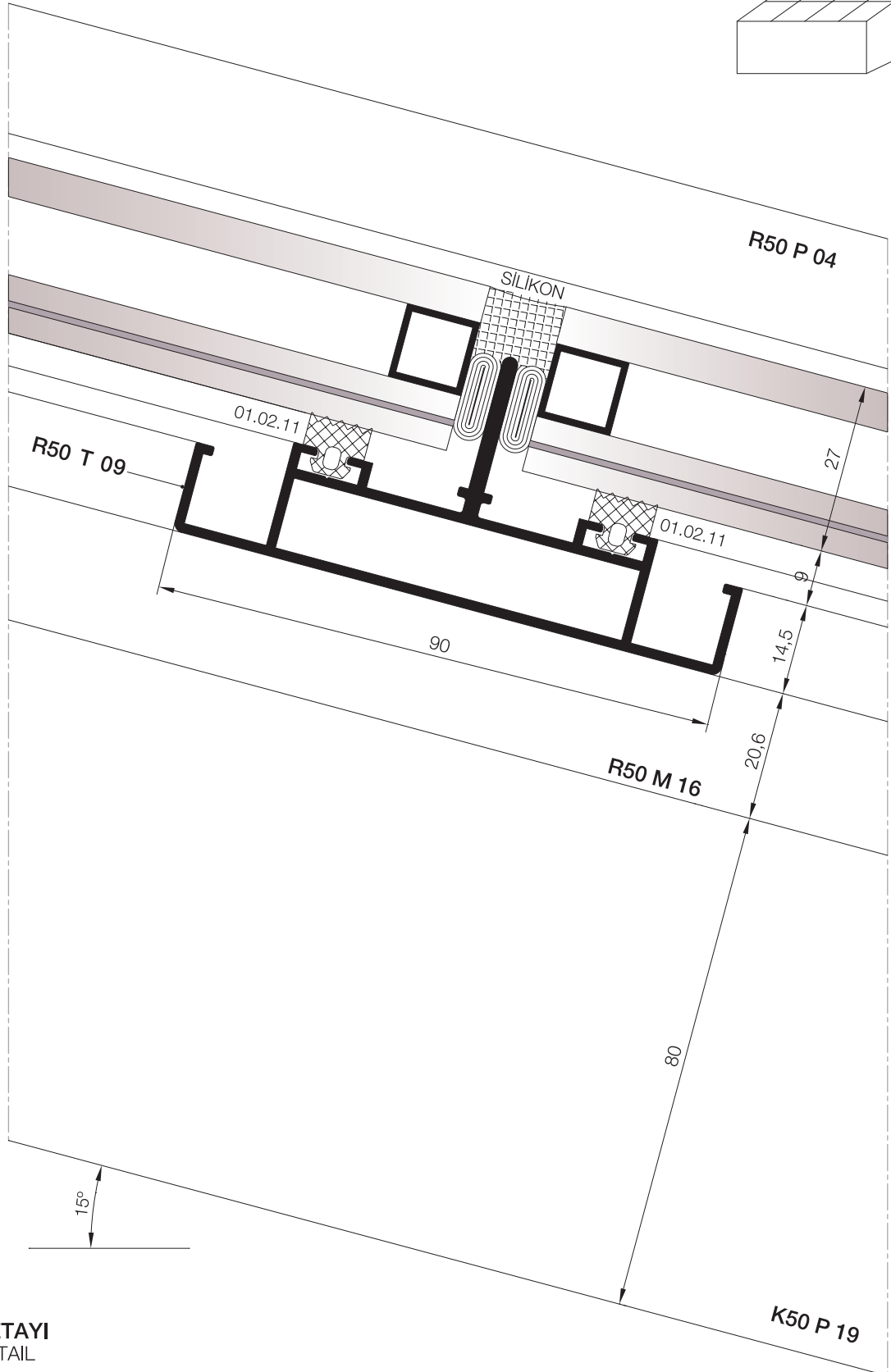
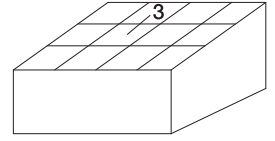

③ DETAYI  
DETAIL



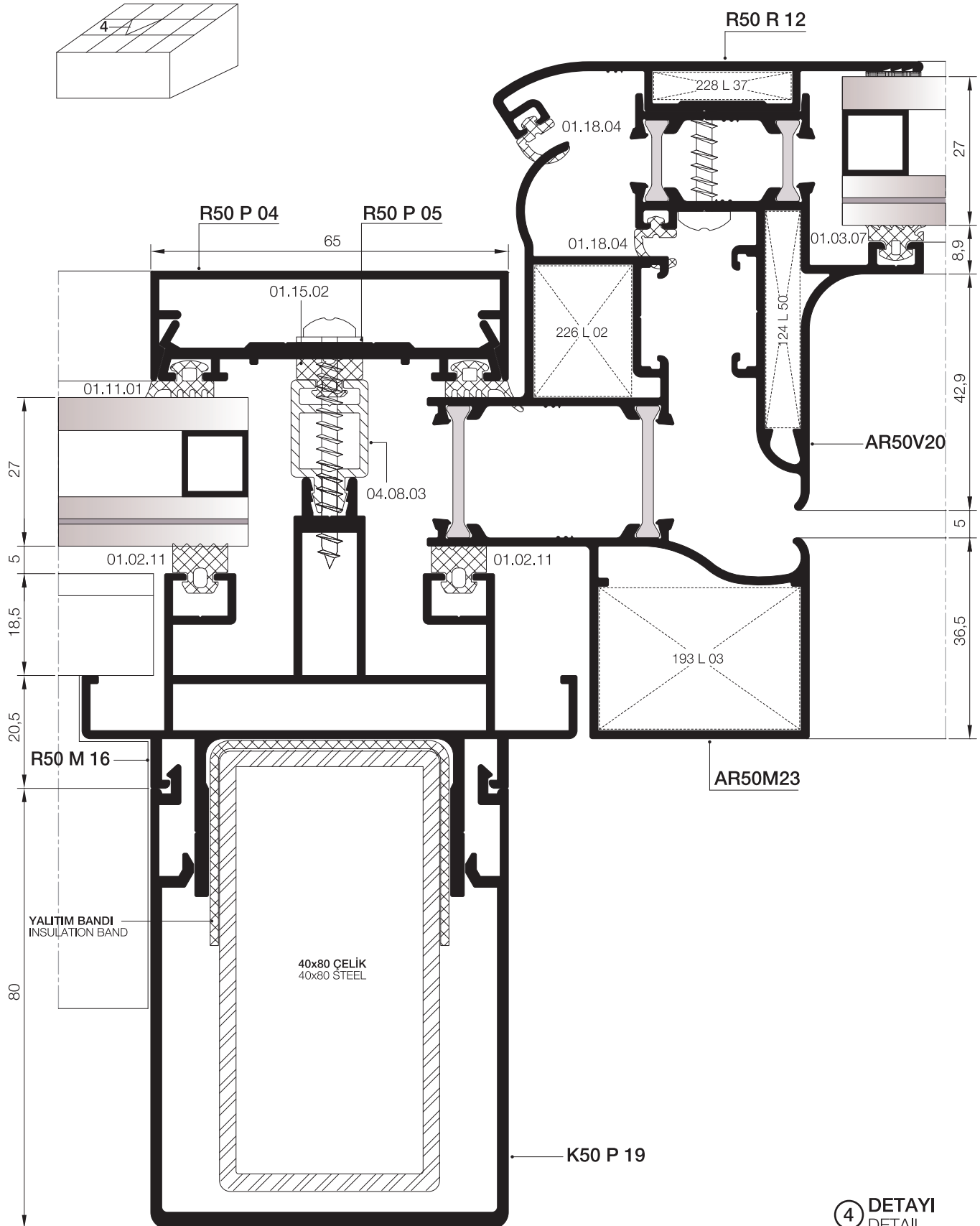

01

02

03

04

05

06

07

08

09

10

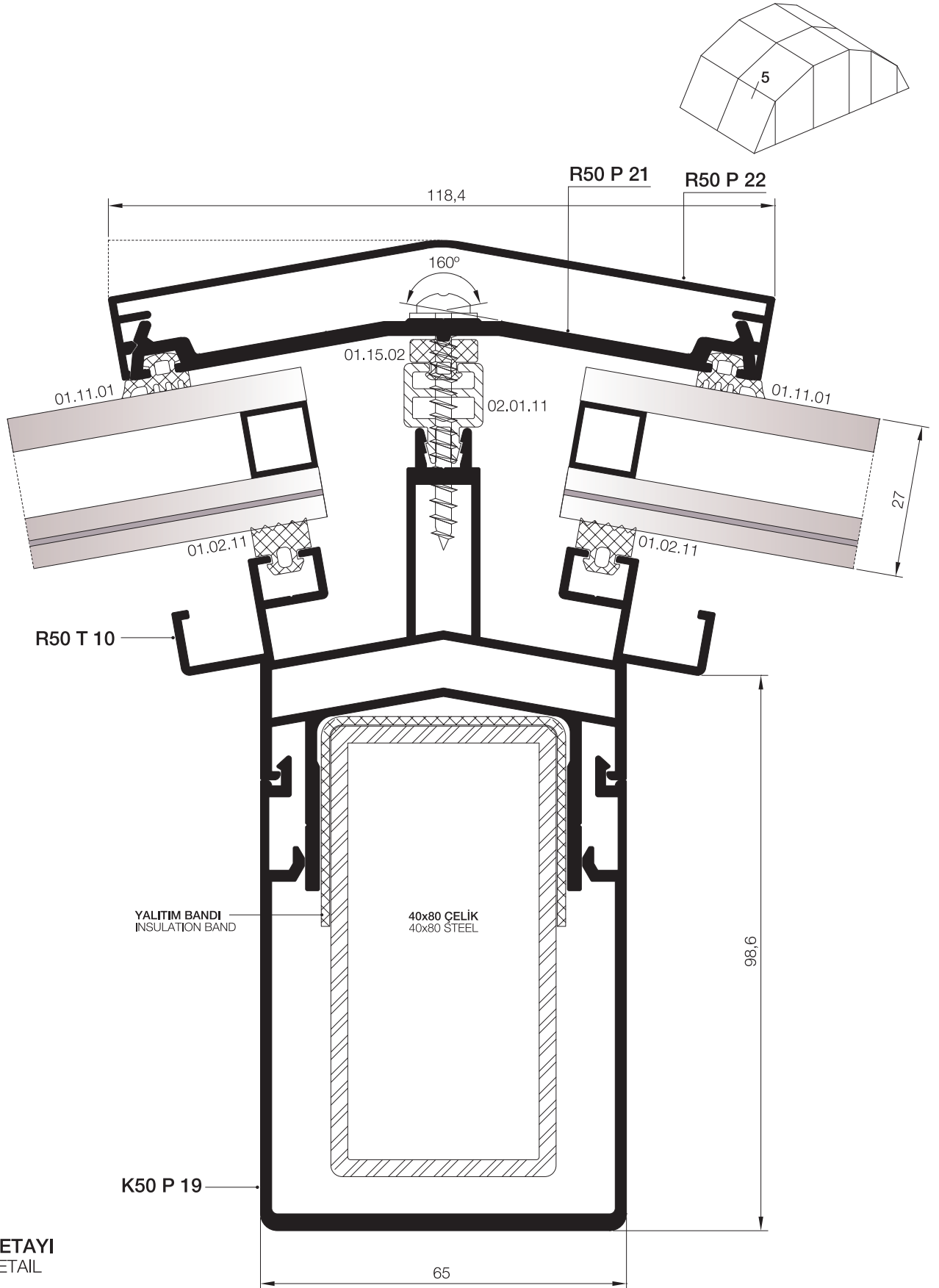

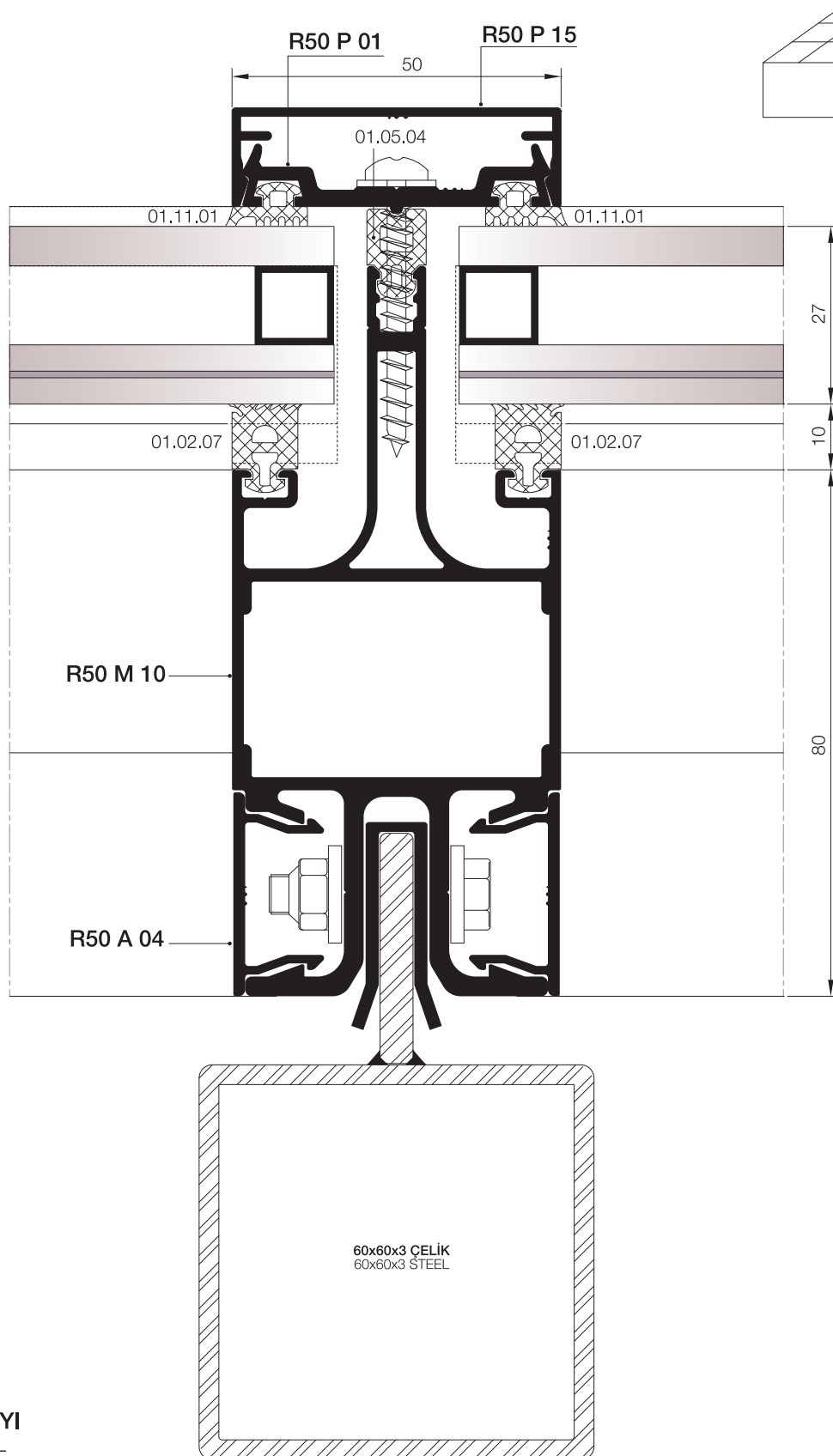

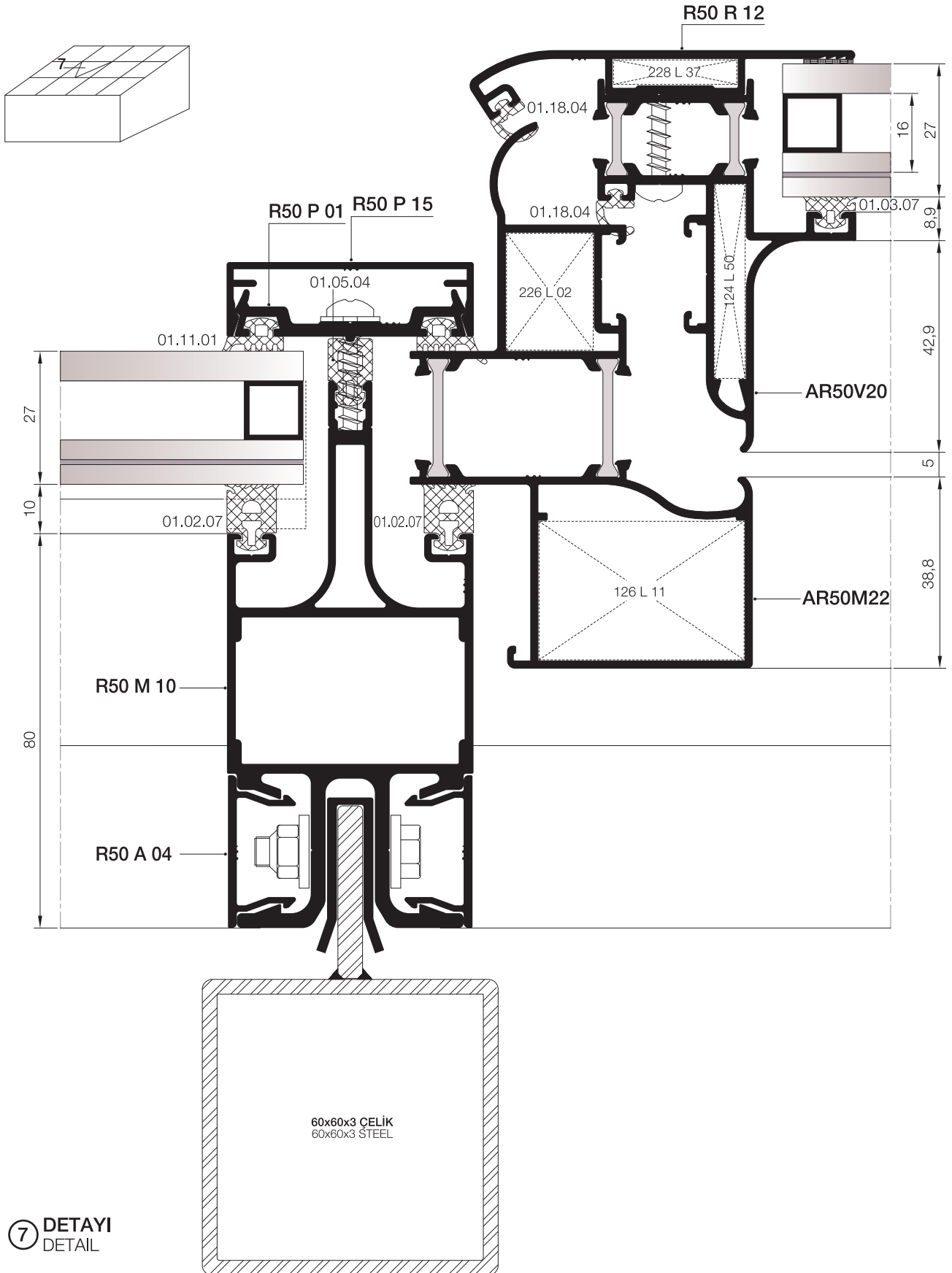

7 DETAYI  
DETAIL

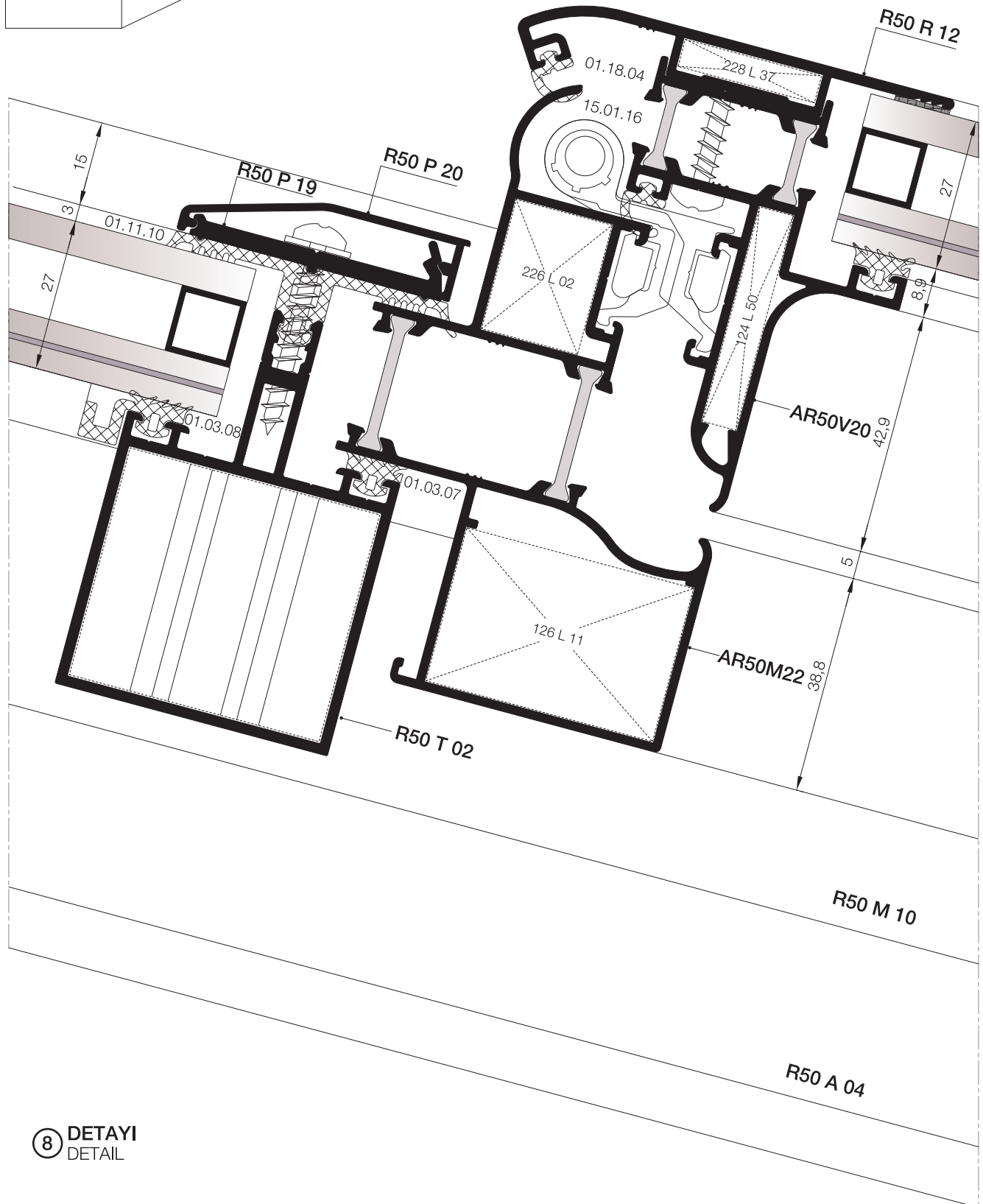
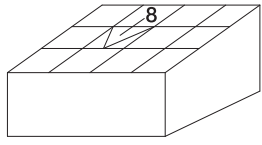

- 01
- 02
- 03
- 04
- 05
- 06
- 07
- 08
- 09
- 10

- 01
- 02
- 03
- 04
- 05
- 06
- 07
- 08
- 09
- 10

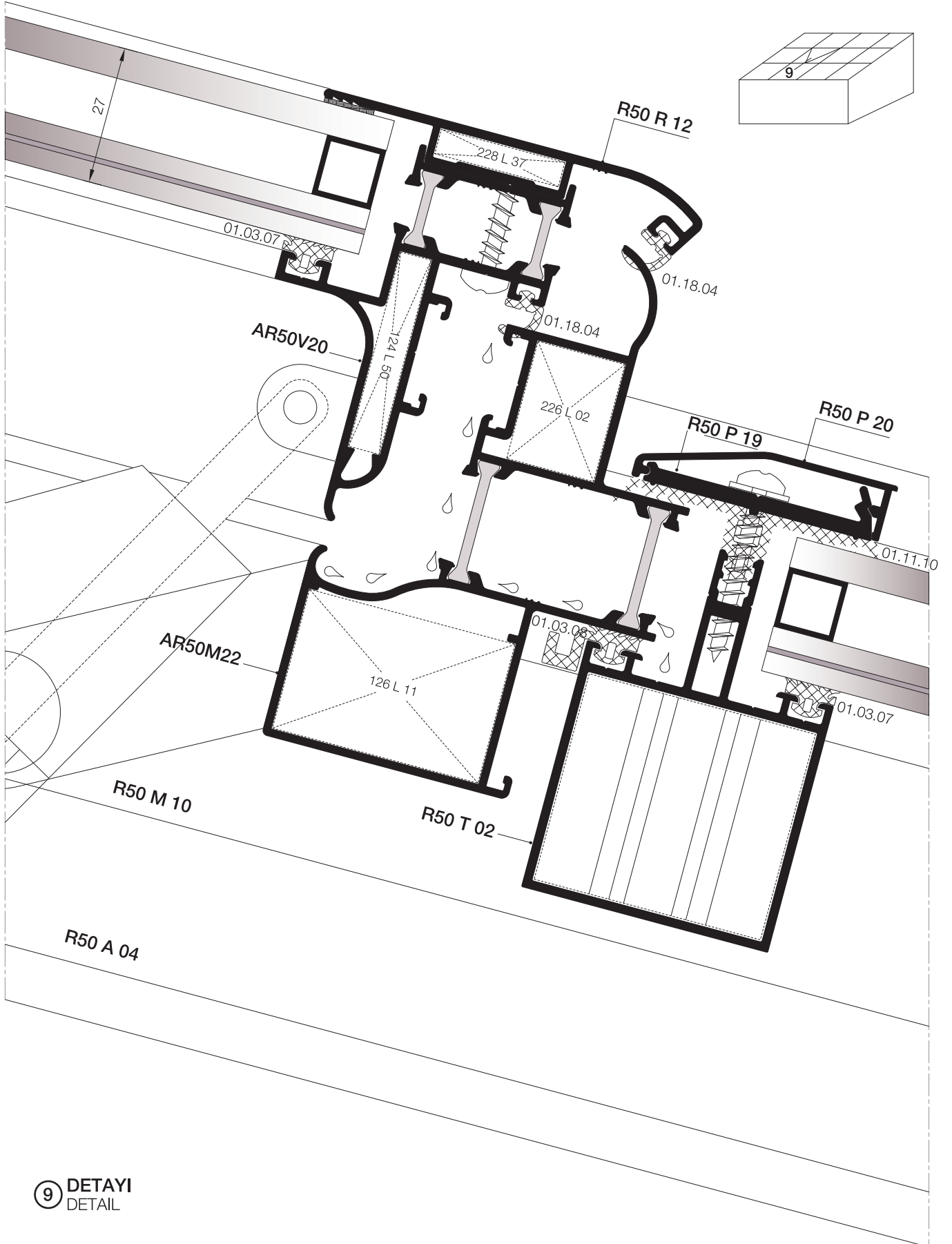

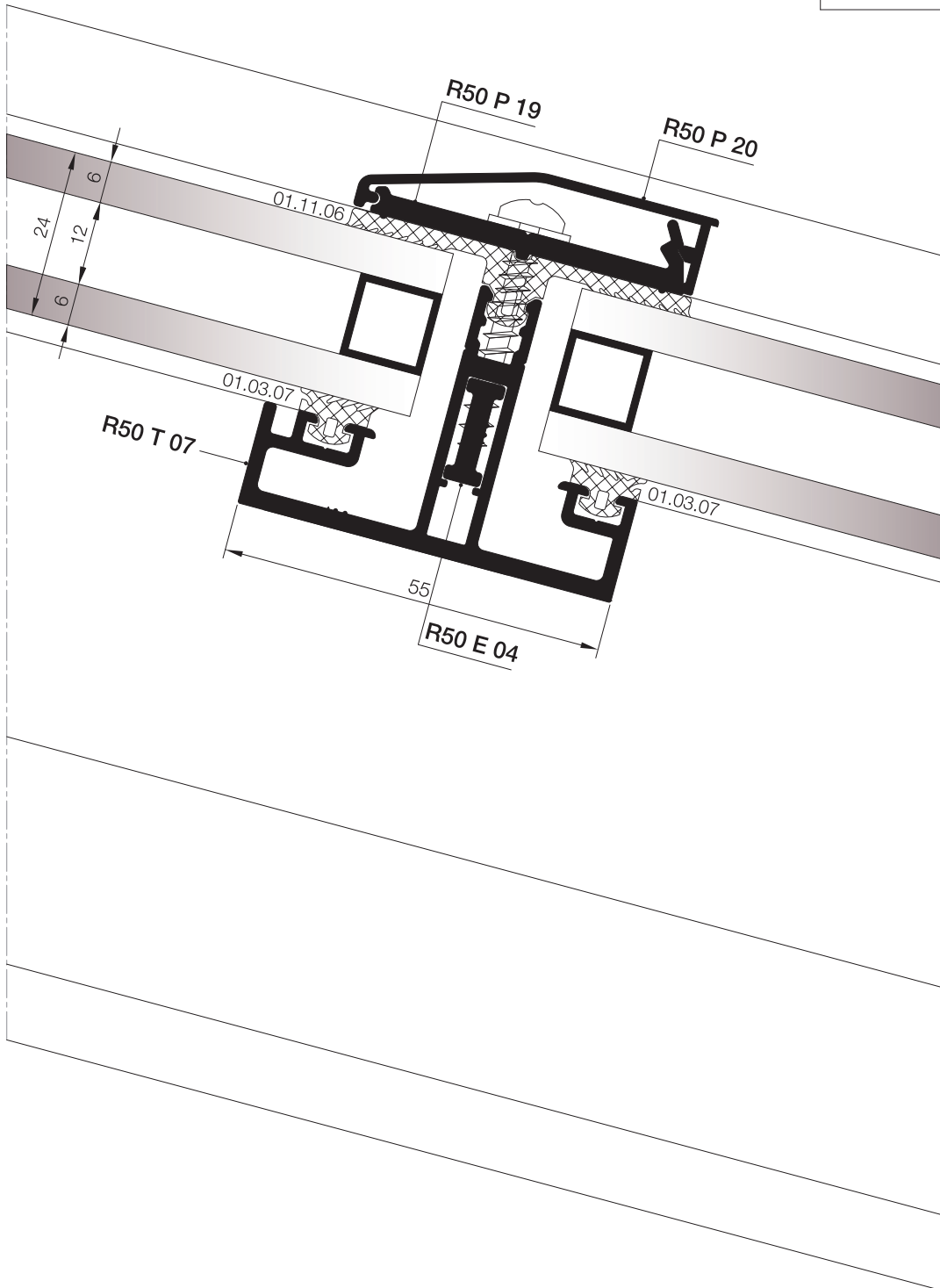
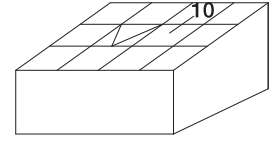

01

02

03

04

05

06

07

08

09

10

